

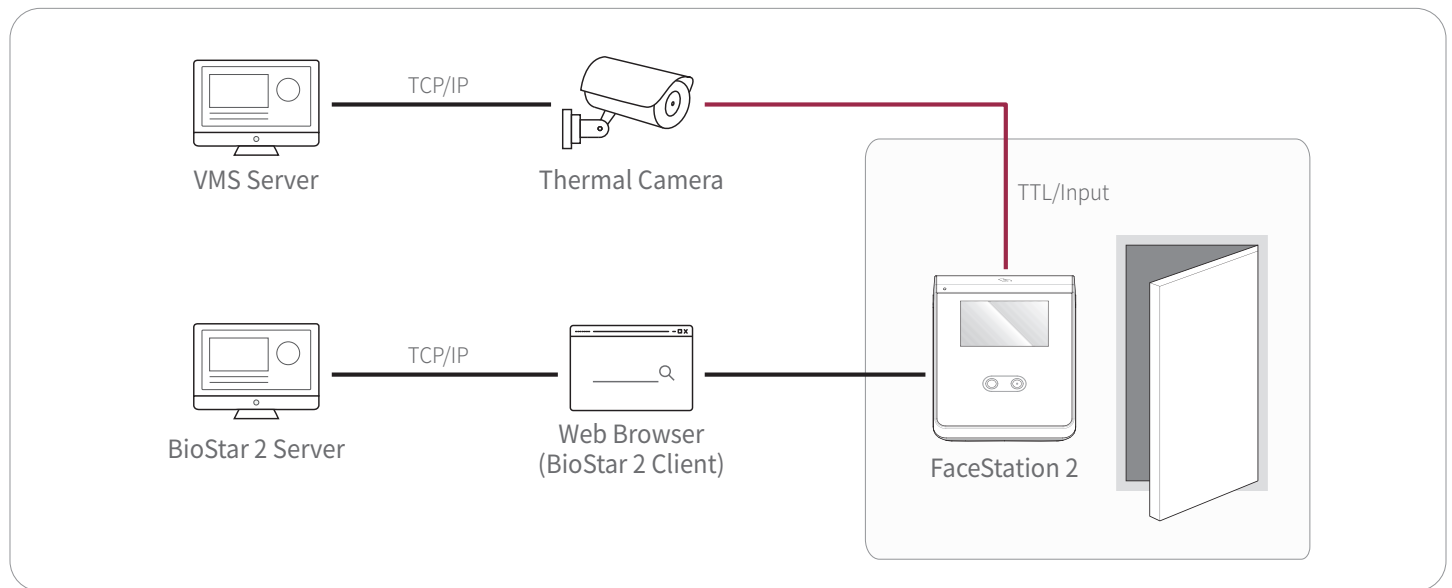

Thermal camera integration With Suprema access control system

- Detect suspected infections through thermal imaging camera
- Support fast, easy and safe verification with Suprema Contactless Solution
- Operate directly by adding a thermal imaging camera without major changes in existing system

System Configuration



Operation example

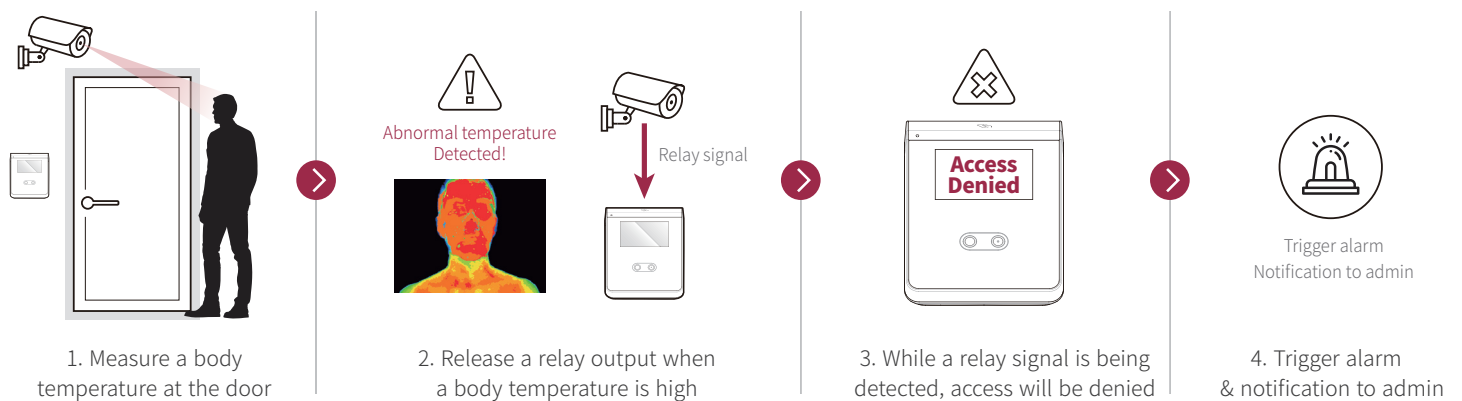

Recommended camera

To use this solution, a thermal camera with below specifications are required.

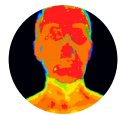

- Capable of Measuring body temperature precisely
- Capable of configuring to release a relay signal when it detects certain level of body temperature



- IO interface for relay signal
- Capable of configuring to relay output duration



Suprema Inc.

17F Parkview Tower, 248, Jeongjail-ro, Bundang- gu, Seongnam-si, Gyeonggi-do, 13554, Rep. of KOREA

T +82 31 783 4502

F +82 31 783 4503

E sales_sys@supremainc.com

www.supremainc.com



For more information about Suprema's global branch offices, visit the webpage below by scanning the QR code.

<https://www.supremainc.com/en/about/contact-us.asp>